

IFU

Wash Test Indicators (WTI) for HYDRIM Washers

Wash Test Indicators (WTI) are used for routine monitoring of the cleaning process in instrument washers. They provide a consistent, reproducible method to routinely check the performance of your automated washer process. WTI's are specifically designed for HYDRIM units with HIP solution.

Follow local regulatory guidelines for the required frequency for performing wash test verification.

Make sure your hands are clean and dry before handling the indicators. Avoid touching the inside square of the indicator.

Follow the 4 steps below before starting the cycle:

1. **TEAR** off the WTI from the sheet (1)
2. **FOLD** the indicator in half at the dotted line (2)
3. **SLIDE** the indicator from the bottom of the plastic holder (3)
4. **ATTACH** the plastic holder on an open basket (4)

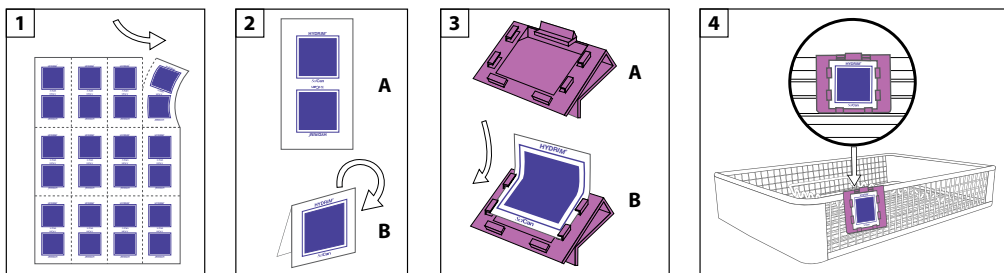

Start the desired wash cycle by selecting P2 or P3. After the cycle is completed, remove the holder and inspect the indicator of any residual color. The purple color should have completely washed away, leaving behind the thick square outline. See some examples of indicators that **PASS** the cycle below (5). Follow local regulatory guidelines for recording the cycle validation data.

FAILED WTI

If there is any noticeable purple color residue on the indicator, the cycle is not validated and the test has failed. Check the following to correct the issue before starting another cycle with a new WTI.

1. HIP solution is not empty and is detected by the HYDRIM
2. Make sure the HYDRIM is not overloaded with cassettes and instruments
3. Make sure WTI being used is not expired
4. HYDRIM unit is not showing any Cycle Faults

Repeat the test using a new WTI in the plastic holder. You can place the plastic holder in the same place or in a new place.

Storage and Disposal

1. Store all indicators in the original package.
2. Store the indicators between 5°C to 30°C (41°F to 86°F) and a humidity of 5% to 80% RH.
3. Do not store the indicators with any disinfectants or chemicals. Keep them away from fumes.
4. The WTI should not be used after expiry date. They may be disposed off with normal waste.

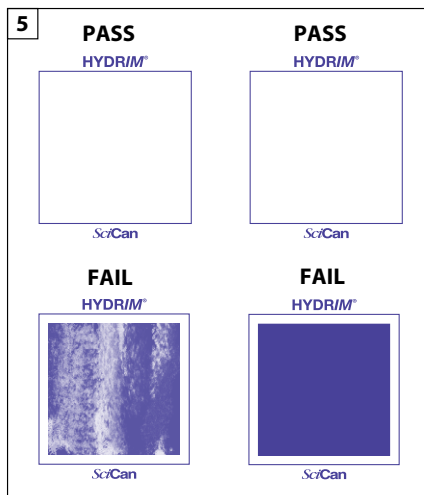

Coltene International Dental Group

Manufactured for:
Dent4You AG
Bahnhofstrasse 2
CH-9435 Heerbrugg

Distributed by:
SciCan Ltd.
1440 Don Mills Rd
Toronto, ON
M3B 3P9 Canada

Distributed by:
Coltène/Whaledent Inc.
235 Ascot Pkwy
Cuyahoga Falls, OH
44223, US